



LED MODULES

SA R-UV LED(2835) Series

Features

- Compact design and easy installation.
- Constant Current (Non-DALI Compatible).
- 170° Wide beam Angle
- Suitable for both indoor and outdoor lighting applications.
- Available colour : Pure White, Red, Blue, Green.
- LED Type: 2835 LED Chip
- 5Years Warranty

Specification

1LED_0.36W

Item Code	Power(W)	Luminous Flux(lm)	Colour	CCT(K)/Wavelength
SA 919A	0.36	53	PW ○	6,500
SA 9194	0.36	53	Red ●	620~625
SA 9195	0.36	53	Blue ●	460~463
SA 9196	0.36	53	Green ●	520~525

2LED_0.72W

Item Code	Power(W)	Luminous Flux(lm)	Colour	CCT(K)/Wavelength
SA 929A	0.72	108	PW ○	6,500
SA 9294	0.72	108	Red ●	620~625
SA 9295	0.72	108	Blue ●	460~463
SA 9296	0.72	108	Green ●	520~525

3LED_1W

Item Code	Power(W)	Luminous Flux(lm)	Colour	CCT(K)/Wavelength
SA 939A	1	150	PW ○	6,500
SA 939A-1(G2)	1	150	PW ○	6,500
SA 9394	1	150	Red ●	620~625
SA 9395	1	150	Blue ●	460~463
SA 9396	1	150	Green ●	520~525



Technical Characteristics

Voltage	DC12V
Viewing Angle	170°
Current Dissipation	0.03A(0.36W) / 0.06A(0.72W) / 0.083A(1W)
Efficiency	150lm/W
Colour	PW / R / G / B
IP Rating	IP65 / IP68 (only SA 939A-1)
CRI(Ra)	80+
PCB	FR4
LED Type	2835 LED
Wire	18AWG

Certification



Temperature Ranges

Operating temperature	-25~60°
Storage temperature	-25~70°

Warranty

Warranty	5 Years
----------	---------

Physical Characteristics

Profile Drawings

1 LED
 Weight : 7 g

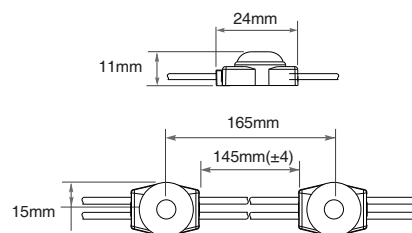

2 LED
 Weight : 10 g

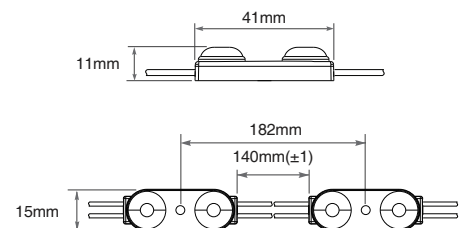

3 LED
 Weight : 16 g

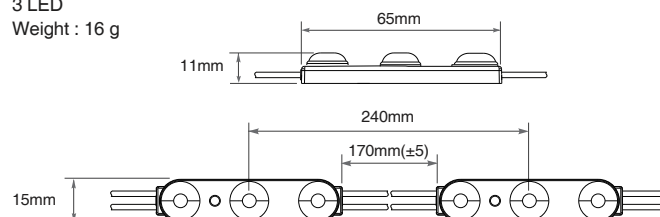

Module Layout Guides

3 LED

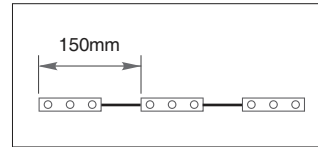

2 LED

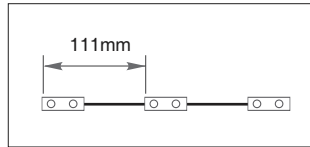

1 LED

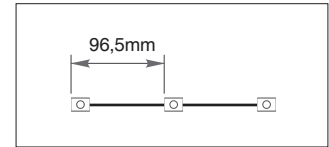

| Lighting Distribution

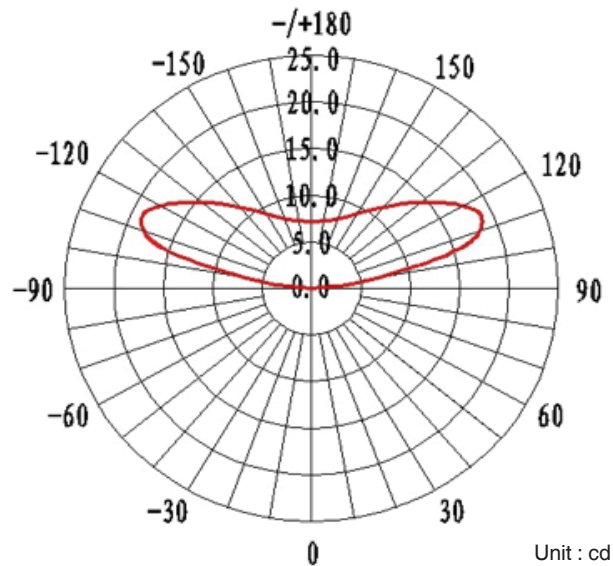

Average Beam Angle(50%) : 159.7°

| Max in series 50 EA

Single series

*Up-to 50 modules in a single series

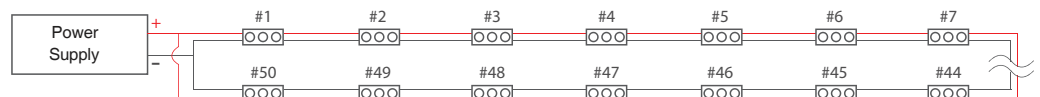

Multiple series

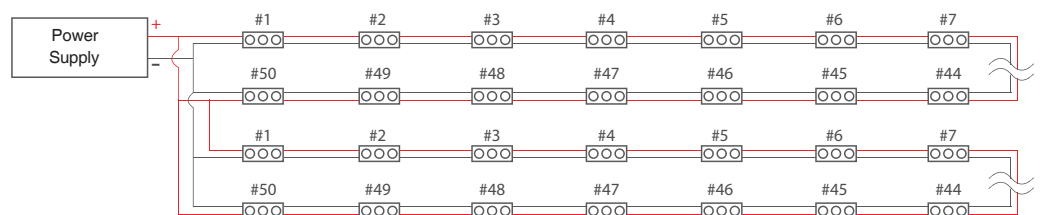

2LED - Max in series 50 EA

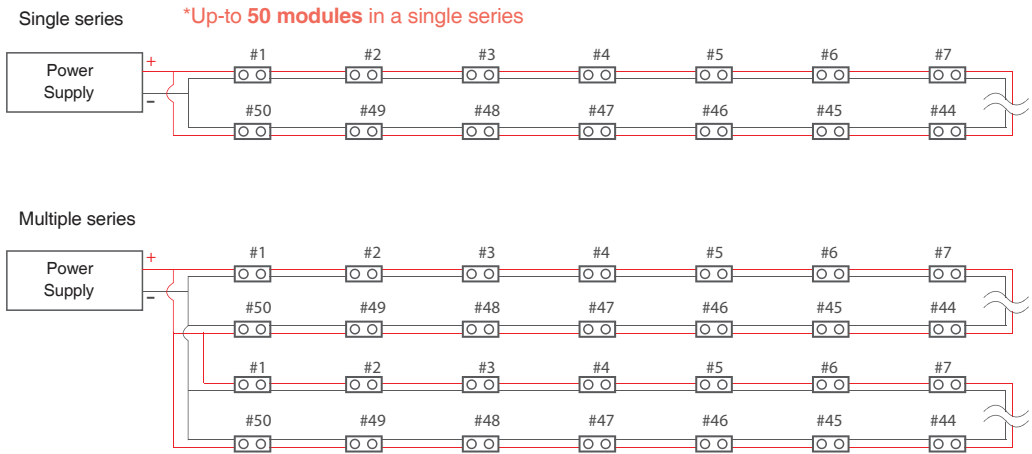

3LED - Max in series 50 EA

